

trendmedic

Professional Breathalyzer
built-in Bluetooth Instruction



Content

• Usage	02
• Test condition	02
• Panel lamp	02
• Power supply	03
• Product description	04
• Operation without printer	05
• Operation with printer	09
• Connect to PC for uploading	10
• Passive test	12
• Failure assistance	14
• Calibration record	15
• Specifications	16
• Settings	17
• Precaution	19

Usage

- The product is used for police or hospital to test alcohol concentration of human body
- **Use Bluetooth to print out the existing test record**
- Record 4000 tested data and can be transmitted onto the PC through Bluetooth

Test condition

- Conduct the test 15 minutes after drinking
- Test environment: $-5^{\circ}\text{C} \sim +40^{\circ}\text{C}$

Panel lamp

- (Green lamp) Charging indicator: in the middle of the panel; the green light will turn off when fully charged.
- (Red lamp) External power supply indicator: on the right of the panel; when there is external power supply, the red lamp will turn on and when not, turn off.
- (Yellow lamp) Bluetooth indicator: on the left of the panel; when the Bluetooth is paired the lamp will turn on and when not, turn off.



Power supply

- Open the battery cover and put in a 3.7V lithium battery (**Nokia BL-5C**) correctly.

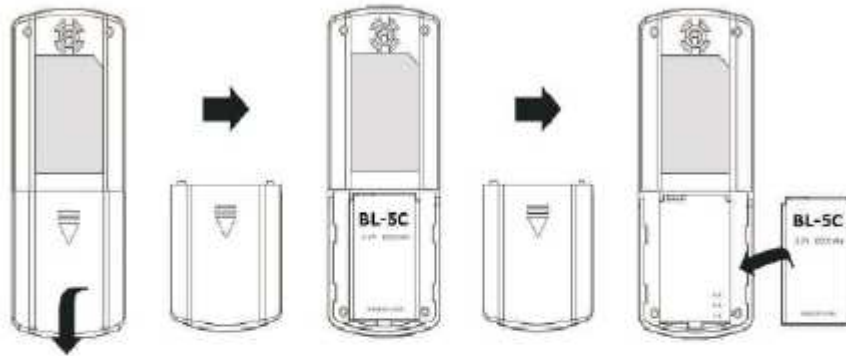

- When running out of battery, the screen will display  in such case the test may not be accurate, please charge the battery in time.
- When there is no battery, use USB cable instead.

Operation

Simple instruction on the back of product:

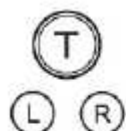

- Press **T** button 1second for power & test
- Press **T** button 5second for power, test & print
- Passive test by holding **R** button at countdown mode
- Standby mode, press **T** button for retest
- Standby mode, press **R** button for recall & print
- Standby mode,press **L** button for power off

How to operate without printer connected

- Insert the mouthpiece (as below)

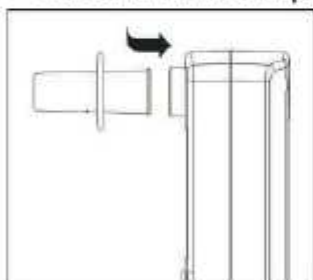

- Press the power button and release when it starts up (for about 1 second)



- LCD will show “8002” and the alcohol tester will count down for testing without Bluetooth connection.



- Get into testing mode, LCD shows “Countdown days” and “number of times tested” remind users of calibration.

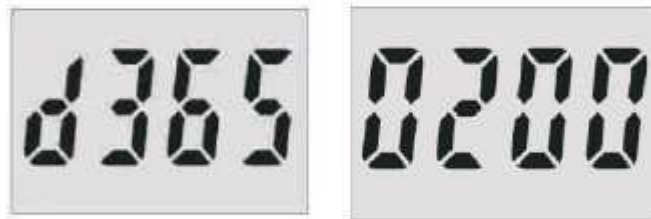

- LCD counters down 06...04...01...



- LCD shows “C-C-” please breathe deeply and blow to the mouthpiece until you hear a “beep” sound. (Blow waiting time is about 3.5 minutes, and user may power-off instantly by pressing left button.)



- Test result will be shown on the LCD (last about 15 seconds).



Standby Mode

- After test the tester will turn into standby mode, with “0000” shown on the screen.



- The standby mode will last for 5 minutes before automatic power off.
- For new test, press **TEST** Button to begin the test at standby mode.

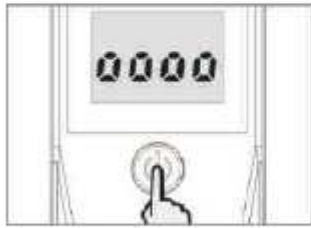

- For instant power off, push the left button at standby mode.



- For recall and print the last record, push the right button at standby mode.



How to operate with Bluetooth printer connected

- Pair the Bluetooth device and input Bluetooth address when using the Bluetooth printer for the first time. See to the Setting part for address input.
- **Do not power-on the printer before LCD shows "8004".**
- Push the power button for 5 seconds to start up the tester.
- **When LCD shows "8004", please wait 5 seconds, and then power-on the printer for pairing Bluetooth.**



- When the pairing is done, the yellow lamp will turn on.

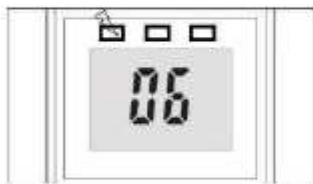

- At this time the tester turns into testing mode and shows counting down numbers, same as normal operation.
- The test data will be transmitted to specific Bluetooth printer for printing simultaneously.
- Then the tester will turn to standby mode.
- If you can't connect the Bluetooth printer successfully, wait for 5 minutes for automatic power off. Or you may press the left key to power off immediately.



Data uploading

- Press and hold the left button and TEST button for starting up. When the LCD shows "8005", it is waiting to be connected with the PC, then use PC to search Bluetooth device and pair it.



- Then operate the Serial Port software to upload. The LCD will show **8006** when the Bluetooth and PC is connected, and the tester will turn into data uploading mode. When all the 4000 records are transmitted (for about 220 seconds), the tester will power off automatically. The transmitting process can't be interrupted.
- For example, use AccessPort software to upload <http://www.sudt.com>. Click the **OPTION** as below for setup COM port, baud rate and so on. And then click **UPLOAD** to begin uploading records.

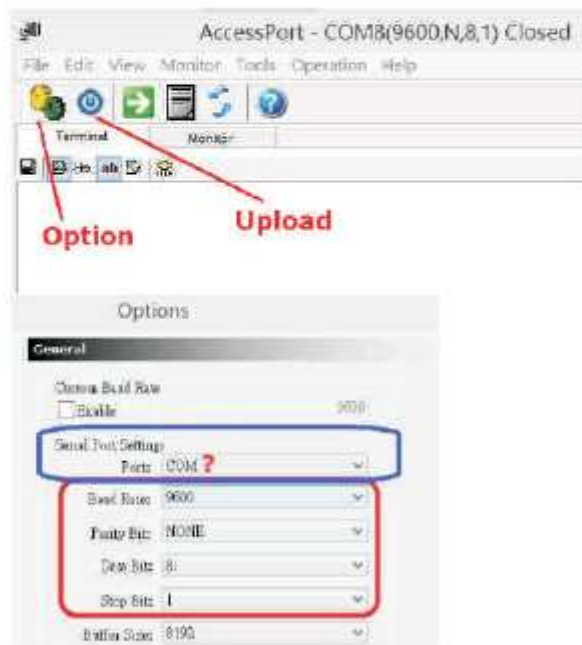

- If the PC can't search the Bluetooth, you may press the left button to power off immediately.



Passive test



- Test with this method when people can't breathe in the correct way.
- When the tester is counting down the numbers (countdown mode), push the right button until you hear a clicking sound of sample taking. Then the tester will show you the result.



Attention

- Only test 15 minutes after drinking, wait for the stabilization of alcohol concentration in human body.
- Blow immediately after counting down and don't stop until you hear a "click" sound.
- If you don't blow, blow too light or discontinuously, LCD will show "Er-b".
- If the temperature exceeds the test range ($-5^{\circ}\text{C} \sim +40^{\circ}\text{C}$), LCD will show "Er-O".
- Calibration needed every 12 months or 1000 times of usage.
- Don't store the tester in the room of corrosive gases.
- Don't put the tester under strong sunlight.
- Avoid falling or strong shaking.

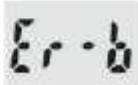
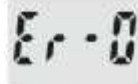
Troubleshooting

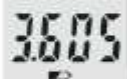
<ul style="list-style-type: none"> No display on LCD 	<ul style="list-style-type: none"> Push the power button for 2 seconds to start up. Connect the charger and try 	
<ul style="list-style-type: none"> Automatically power off 	<ul style="list-style-type: none"> Low battery Exceeds standby duration. 	
Er-b	<ul style="list-style-type: none"> Blow too short or too long. Unstable blowing 	
	<ul style="list-style-type: none"> Beyond operating 	
<ul style="list-style-type: none"> Failure of Bluetooth printing 	<ul style="list-style-type: none"> Take the tester closer to the Bluetooth printer Check the setting of Bluetooth address 	
<ul style="list-style-type: none"> Failure of Bluetooth uploading 	<ul style="list-style-type: none"> Check whether the Bluetooth is on and paired with the PC Correct option setup on 	
	<ul style="list-style-type: none"> Blood alcohol concentration 	
	<ul style="list-style-type: none"> Low battery and voltage Need to be charged 	
<ul style="list-style-type: none"> Alarm sound 	<ul style="list-style-type: none"> Error operating indication Test result exceeds alarm setting Calibration needed after 	

Calibration Record

- Fail to calibrate the tester every 12 months or after 1000 times usage may cause inaccuracy of testing.

Calibration record :			
Date of the first usage		Serial number	
#	Calibration time	Note	Calibration done

Specifications

- 19mm electrochemical sensor (fuel cell sensor)
- **Print out and uploading data by Bluetooth**
- Recall last result for display and print
- Blow waiting time is **3.5** minutes, and may power off instantly
- Blow duration: about 4~ 6 seconds
- Test result display range: 0.000~4.000‰ (0.40% or **2.00mg/L**)
- Display "HI" when the test result exceeds the range
- LCD turns into red light when the test result exceeds alarm limit.
- Preheating time: 6 seconds
- Testing time: <10 seconds
- Waiting time for retesting: <30 seconds
- LCD displays 4 digits of test result, with backlight for night use.
- Use 3.7V lithium battery (BL-5C), use USB or DC5V for charging
- Recording the times and days of usage (warning for 1000 times or 365 days)
- Calibration needed every 1000 times or 365 days of usage
- Low battery indication and automatic powering off
- Testing environment: -5℃ ~ + 40℃
- Storage temperature: -10℃ ~ + 45℃
- Product dimension: 140x55x34 mm
- Multi-language printing: English, Chinese, Spanish, Russian
- Practicable test method: Active or passive
4000 data records
- CE, RoHS Certification and FDA device listed
- Comply with EN15964

Settings of tester

- Press ▲ (left)+ TEST(middle) to enter setting mode
- Get into setting of pass word, time (year, month, day, hour, minute), temperature, unit, alarming point, printing language, and Bluetooth address.

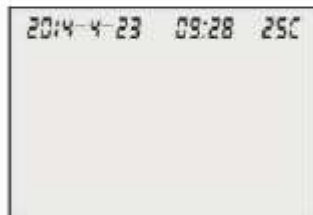

- Press left button ▲ to enter the next setting (turn to the next setting automatically after 5 seconds without any operation)



- Press ▼ (right) button to increase one unit and long press it for continuous increasing. (Note: It will turn back automatically at the maximum)
- When all the settings are done, the buzzer will sound once and save the settings, and then turn to operational mode.

Detailed setting menu

- LCD shows COdE and P0- - ; continue the following settings after you've input the correct pass code: P003.

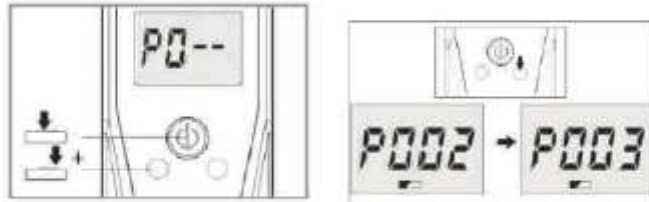

- Date: 2013-03-20 (yyyy-mm-dd)
- Time 00:00 (24 hour mode)
- Temperature C; F
- LCD shows UnIt to remind you to get into unit setting mg/L; %; ‰(g/l); mg/100ml
- LCD shows ALAr to remind you to get into alarm point setting. The default point is 0.500‰; press the right button to choose between 0.10 ~ 0.90‰.
- LCD shows LAng to remind you to get into printing language setting: EN, CN, ES,RU.
- LCD shows Addr to remind you to get into Bluetooth printer address setting. The address (can be found on the self- test page on the printer) has 12 digits; you may press the left button to set the next digit and it will turn to the setting of the next digit automatically after 5 seconds without any operation.

Precautions

- Alcohol concentration in the blood changes with body metabolism, and test result varies with it.
- For your safety, don' drive after drinking.

